

WALL SLEEVES

asbestos-free fiber
cement

MULTITUDE OF SUITABLE WALL SLEEVES
FOR ANY APPLICATION: MATERIAL
CLASS A1 ACCORDING TO DIN EN13501-1

HYDROSTATIC SEALING,
MFPA-LEIPZIG TESTED AND
CERTIFIED UP TO 5 BAR

WALL SLEEVE OF
FIBER CEMENT ALSO
IN SPLIT VERSION

WWW.SERCO21.HU



GENERAL INFORMATION

An economic and secure method to seal hydrostatically

The asbestos-free fiber cement wall sleeves are - in connection with LINK-SEAL® or Kompakt seals - the right accessory whenever steel, cast iron, copper or plastic pipes pass through walls, ceiling or floors.

Material

Asbestos-free fiber cement, consisting of cement and fiberglass, color light grey. Material class A1 according to DIN EN13501-1.

Specifications

Corrosion resistant, leak-proof against pressing water, electrically insulating, non-inflammable, high stability, good connection with concrete, can be coated, circumferential grooves, smooth inner walls, high dimensional stability, split version available for retrofitting, all lengths from ND 80-800 sizes up to max. 1.200 mm available.

The sleeve can either be set in concrete, walled in or be plastered into a wall penetration to be water-tight. The circumferential grooves on the outside provide a water tight and homogeneous bonding with the building. For usage in a concrete pool or container, the wall sleeve can be backed with a coating of the concrete construction. Function and compound of the wall sleeve with the concrete is certified by the MFPA-Leipzig up to 5 bar.

In connection with our original LINK-SEAL® or Kompakt seals, an absolutely pressure and water tight sealing of the annular space between fiber cement wall sleeve and pipe will be achieved.

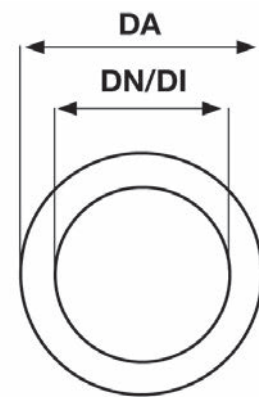

Technical Data

Size	Dimensions							
	Inner diameter (ID in mm)		Outer diameter (OD in mm)		Excentricity Core max	Length	Form Grooves	Cut Offset
	Nominal size	Tolerance	Nominal size	Tolerance				
ND 80	80	+2/-1	120	+5/5	1,5	+/-3	A	0
ND 100	100	+2/-1	140	+5/5	1,5	+/-3	A	0
ND 125	125	+2/-1	165	+5/5	1,5	+/-3	B	0
ND 150	150	+2/-1	190	+5/5	1,5	+/-3	B	0
ND 200	201	+2/-1	250	+5/5	1,5	+/-3	B	0
ND 250	250	+2/-1	300	+5/5	1,5	+/-3	B	0
ND 300	300	+2/-1	350	+5/5	1,5	+/-3	B	0
ND 350	350	+2/-1	400	+5/5	1,5	+/-3	B	2
ND 400	400	+2/-1	460	+5/5	1,5	+/-3	B	2
ND 450	450	+2/-1	510	+5/5	1,5	+/-3	B	2
ND 500	500	+2/-1	570	+5/5	1,5	+/-3	B	2
ND 600	600	+3/-2	670	+5/5	1,5	+/-3	B	2
ND 700	700	+3/-2	780	+5/5	1,5	+/-3	B	3
ND 800	800	+3/-2	880	+5/5	1,5	+/-3	B	3

Subject to technical changes, further sizes upon request.

Order description

Fiber-cement wall sleeve, ND size, length.



Version: closed/split. For split version additional putty is necessary. Available as a set with spacer, container at 1 kg.

Consumption about 125 g. per 100 mm sleeve length.

TECHNICAL DATA

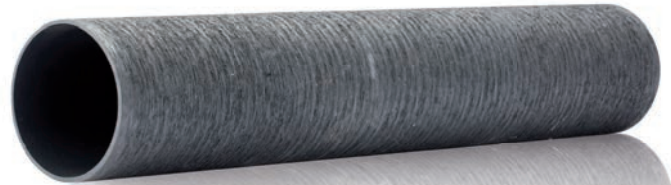
PVC wall sleeve suitable for concreting or bricking in. They are supplied in standard lengths of 400 mm and can be easily trimmed to the wall thickness on site.



Descriptions	Inner diameter in mm	Outer diameter in mm	Length* in mm
Wall sleeve PVC 	50	54	400
	60	65	400
	70	75	400
	80	85	400
	90	95	400
	100	106	400
	125	131	400
	150	160	400
	200	210	400
Reinforced wall thickness	82	90	400
	100	110	400
	250	280	400
 Wall sleeve with shaped socket and lip seal	Inner diameter in mm	Inner diameter socket in mm	Length in mm
	100	110	500
	100	110	800
	100	110	1000
	100	110	110
	150	160	110
	100	110	250
	125	131	250
	150	160	250
	100	110	300
	125	131	300
	150	160	300

*Other lengths upon request

Accessories

Casing aids made of PE-LD 	Ø Inner diameter PVC wall sleeve in mm
	60
	80
	100
	125
	150
	200
	250

Further sizes upon request

GENERAL INFORMATION

An economic method to seal hydrostatically

When penetrating steel, cast iron, copper or plastic pipes through walls, ceilings or floors, the wall sleeves are the best method to create a perfect hole inside the wall and provide best conditions for a seal to work.

Wherever the LINK-SEAL® modular seal is used to seal the annular space between the carrier pipe and the wall penetration, it makes sense to use the wall sleeve.

The wall sleeves are made of welded or seamless steel pipes. They are galvanized to protect them against corrosion. Other corrosion protection measures are available upon request (e.g. electrostatic powder coating).

The standard sleeve is supplied with a welded-on anchor flange. It acts as an annular water-stop plate which provides a 100% seal around the outer diameter and also serves as a wall anchor.



Important ordering information

Wall sleeve diameters need to be selected to accurately fit the respective pipe and corresponding Original LINK-SEAL® modular seal. When ordering wall sleeves, please specify dimensions for D, L, L1, the outer diameter of the carrier pipe to be passed through, and the desired Original LINK-SEAL® modular seal type.

Example: wall sleeve
 168.3 x 4 (D = Sleeve outer diameter)
 300 (L = Length of sleeve in mm)
 150 (L1 = Arrangement of flange)

Order description: wall sleeve, 168.3 x 4 - 300 - 150

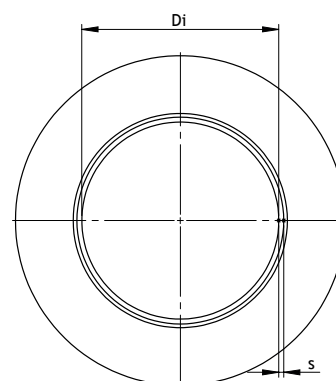
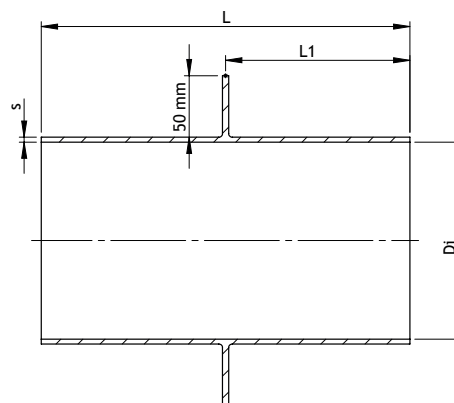

More content can be found
 on www.serco21.hu



Phone: 00 36 20 936 5430
Fax: 00 84 510 924
E-Mail: office@serco21.hu

www.serco21.hu